



FIREMAC 2000

The Firemac 2000 is a flap type ventilator suitable for natural and smoke extraction. Various options are available within the range providing flexibility and choice for the designer and customer. These include insulated and uninsulated versions along with units incorporating translucent polycarbonate tops for providing natural daylight. A further option is a unit with a thermally separated construction.

The variety of options and low profile appearance make the Firemac suitable for industrial buildings, shopping centres and atria. Smoke exhaust from stairwells is an ideal application for this unit.

MATERIAL

Corrosion resistant mill finish aluminium.

FIREMAC 2000

OPERATION

P2 double-acting compressed air operation

M motor operation

Suffix: **B** fire function **FS** failsafe (P model only)

BASE OPTIONS

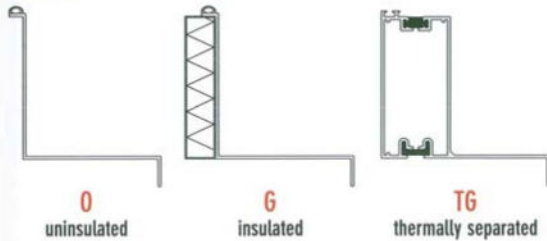

FLANGE OPTIONS

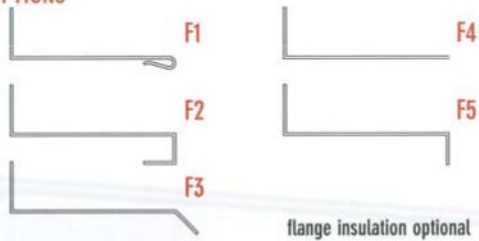

FLAPS

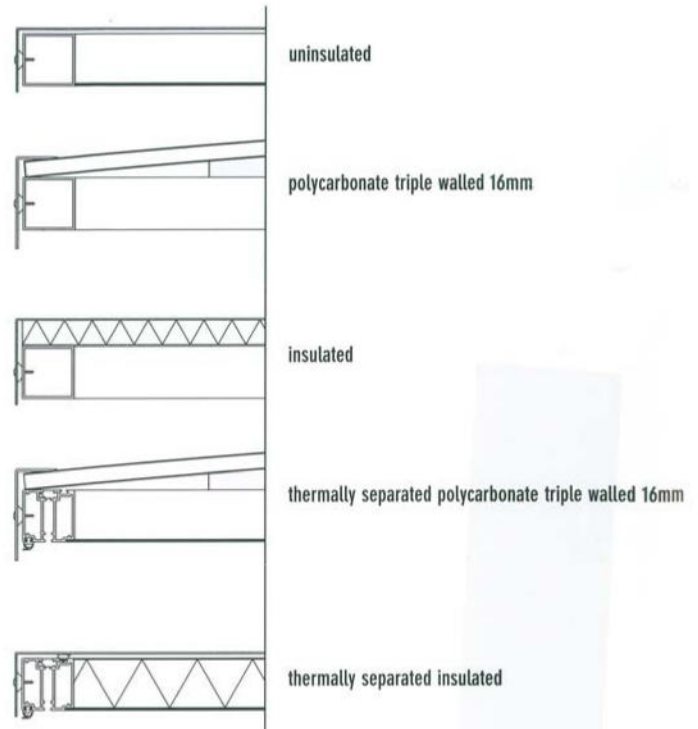

Single Flap

Unit	throat width (mm)	throat length (mm)	Throat Area (m ²)	Aerodynamic Free Area (m ²)
1010	1000	1000	1.00	0.60
1015	1000	1500	1.50	0.90
12.510	1250	1000	1.25	0.75
12.515	1250	1500	1.88	1.13
12.520	1250	2000	2.50	1.63
12.525	1250	2500	3.13	2.03

Twin Flap

Unit	throat width (mm)	throat length (mm)	Throat Area (m ²)	Aerodynamic Free Area (m ²)
1010	1000	1000	1.00	0.60
1015	1000	1500	1.50	0.90
1510	1500	1000	1.50	0.90
1515	1500	1500	2.25	1.35
1520	1500	2000	3.00	1.80
2015	2000	1500	3.00	1.80
2020	2000	2000	4.00	2.60
2025	2000	2500	5.00	3.25
2520	2500	2000	5.00	3.25
2525	2500	2500	6.25	4.06

CROSS SECTIONS

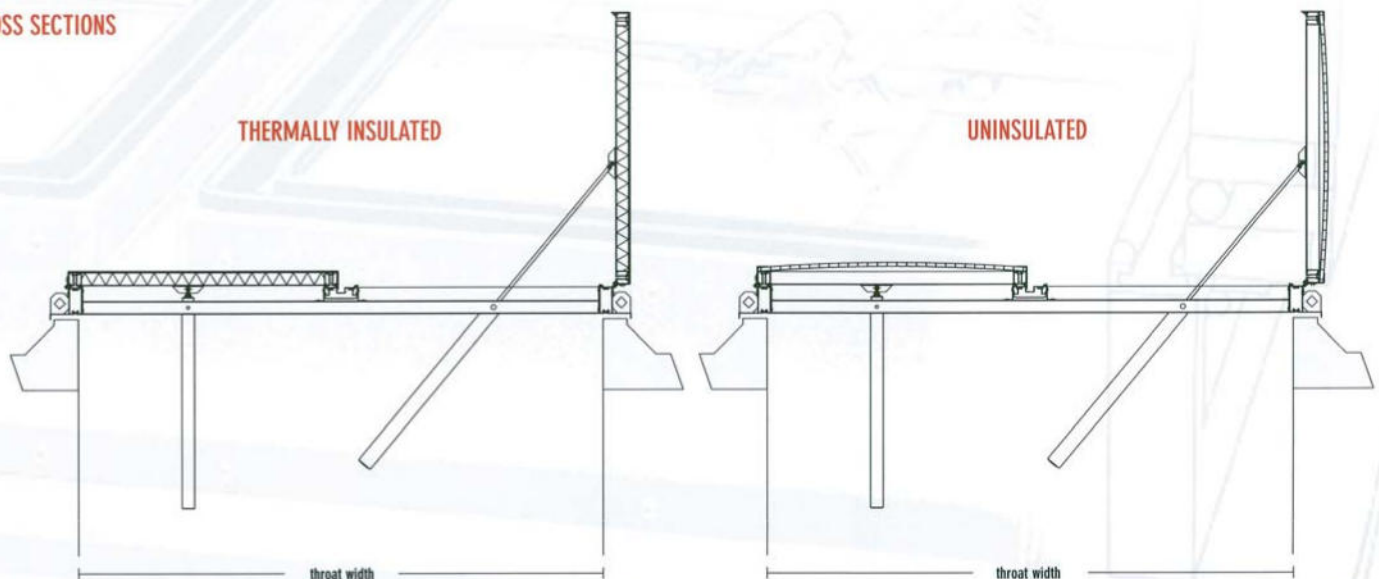

Due to a policy of continuous improvement, alterations in the specifications may be made at any time without notice.

The company accepts no responsibility for any discrepancies which may occur between the specification of its equipment and the descriptions contained in its publications.

McKENZIE MARTIN LIMITED

ETON HILL WORKS, ETON HILL ROAD, RADCLIFFE, MANCHESTER, M26 2US

TEL: 0161 723 2234 FAX: 0161 725 9531 EMAIL: general@mckenziemartin.co.uk

Revision 01/11 DE